



# My First Home Tank Topper

Home measures 20" L x 10" W x 10" H

## Assembly Instructions

DESCRIPTION	MATERIAL NO.	UPC
My First Home Tank Topper	100079041	045125600032

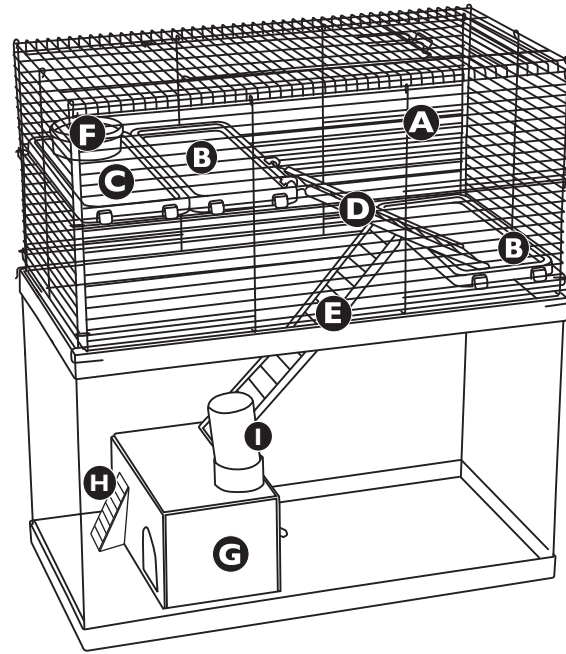

### Important:

Carefully Unpack and Sort All Components on the Parts List

QTY.	KEY	DESCRIPTION
1	A	Wire Panel Set
2	B	10" Comfort Shelf
1	C	10" Comfort Shelf with Opening
1	D	9" Safety Ramp
1	E	12" Safety Ramp
1	F	Food Dish
1	G	Little House
1	H	Stairs
1	I	Water Bottle

If your new pet home has experienced damage during shipping, please do not return your cage to the store.

Our Customer Service Department is available to help with any problems. Our Toll-Free Number (within the USA and Canada only) is 800-255-4527, Monday - Friday from 8:00 a.m. to 4:00 p.m. (Central Standard Time).

**SAVE YOUR INSTRUCTIONS FOR FUTURE REFERENCE**

Manufactured by: KAYTEE Products, Inc., Chilton, WI 53014 USA  
 ©2017, 2018 KAYTEE Products, Inc.  
 Made in China  
 Kaytee and Kaytee with design are registered trademarks of Kaytee Products, Inc.  
 For more information on bird and small animal products, visit us at: [kaytee.com](http://kaytee.com)

PP1005817

### STEP 1 Unwrap Wire Panel Set

Unwrap the Wire Panels (A) and lay on a flat surface with the doorway facing upward.

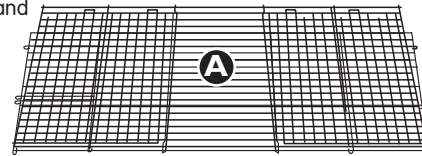

### STEP 2 Unfold Wire Panel Set

Carefully unfold the Front, Back, and Side panels.

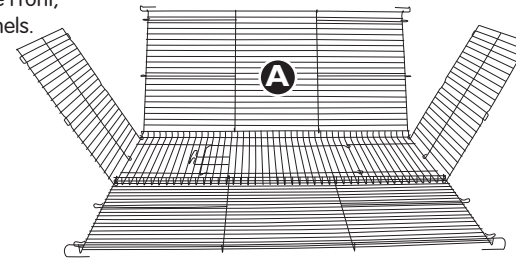

### STEP 3 Lock Side Panels to Back Panel

Lock the Right and Left Side Panels onto the Back Panel.

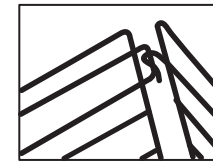

Snap the wire hook through the wire loop.

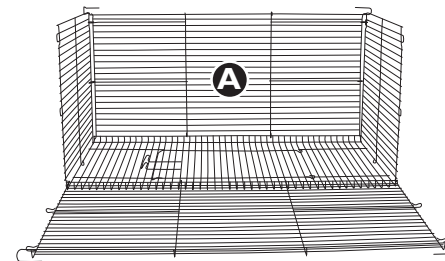

### STEP 4 Lock Front Panel to Side Panels

Next lock the Front Panel onto the Side Panels.

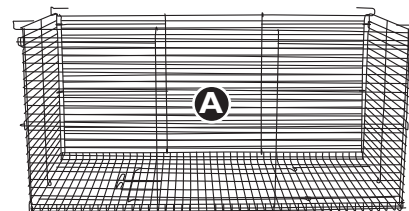

Special Note: If the wire hooks have become bent during shipping, carefully pry them open to fit into the side panel wire loops.

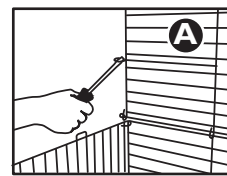

### STEP 5 Position Comfort Shelf

Flip Wire Set to upright position. Position the Comfort Shelf with Opening (C) on the 9th full-length wire bar down from the top on the left hand side, with the opening toward the rear of the home. Press down so that shelf locks firmly into place.

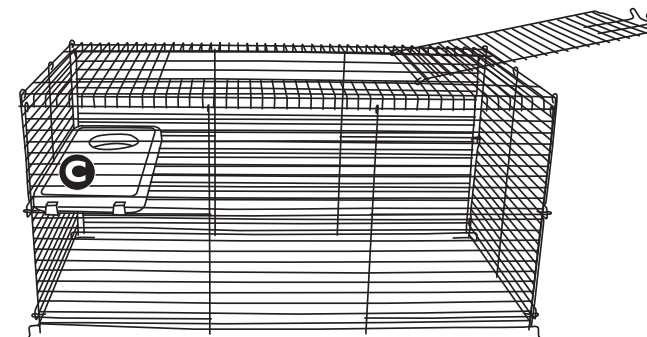

### STEP 6 Position 2nd Comfort Shelf

Position one of the remaining Comfort Shelves (B) next to the shelf just installed. Press down so that shelf locks firmly into place next to the Comfort Shelf with Opening.

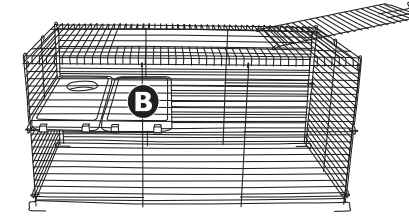

### STEP 7 Attach Bottom Comfort Shelf

Position the final Comfort Shelf (B) on the 2nd full-length wire up from the bottom on the right hand side. Press down so that shelf locks firmly into place.

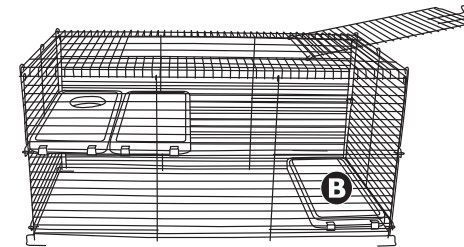

### STEP 8 Attach Safety Ramp

Attach the Safety Ramps (D & E) to the Comfort Shelves by clipping the two tabs on the Ramp to the edge of the Comfort Shelf. Attach the 9" Safety Ramp (D) onto the top left shelf toward the front of the home. Attach the 12" Safety Ramp (E) onto the lower right shelf towards the rear of the home and lock in place.

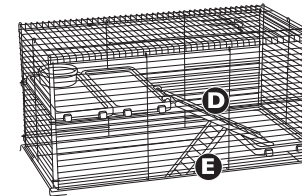
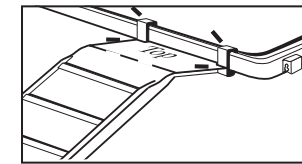

### STEP 9 Insert Food Dish

Place the Food Dish (F) in the opening in the upper left Shelf.

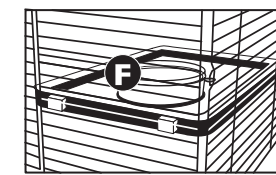

### STEP 10 Assemble House

Assemble the Little Brick House (G) by folding the front, back, and sides inwards and locking the tabs in the corners of the front and back walls into the openings on the side walls.

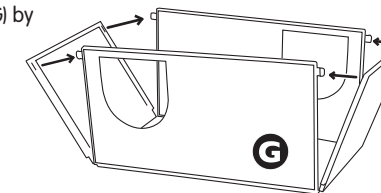

### STEP 11 Attach Stairs

Attach Stairs (H) to Little Brick House (G) by pressing the tabs on the back of the Stairs into the slots on the wall of the House.

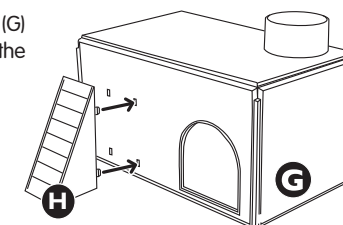

### STEP 12 Insert Water Bottle

Insert Water Bottle (I) into opening in the top of the Little Brick House (G), so that the sipper tube on the Bottle emerges from the small oval opening on the front of the House.

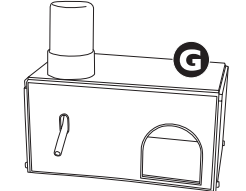
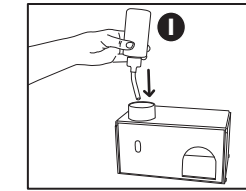

### STEP 13 Place Items into Base

Place Little Brick House with Stairs and Water Bottle into the base of the 10 gallon tank, toward the left hand side.

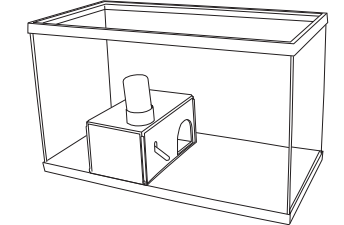

### STEP 14 Assemble Cage

Place the assembled wire Tank Topper with shelves and ramps on top of the 10 gallon tank. You may adjust the wire tabs on the bottom of the Tank Topper to get the best fit for your tank (tank sold separately).

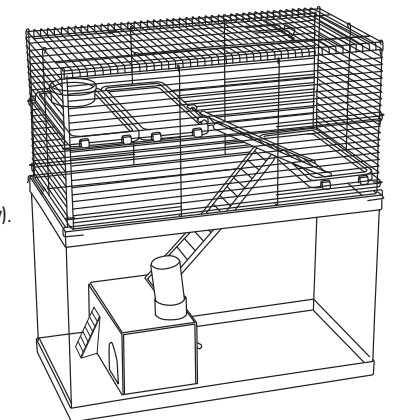
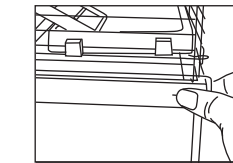

Tip: The Tank Topper and aquarium must be carried and/or lifted by carefully picking up the glass aquarium. Do not lift the tank and wire assembly by lifting the Tank Topper (aquarium sold separately).

### STEP 15 Secure Wire to Base

Clip Spring Latches to the rim of the tank to secure the home.

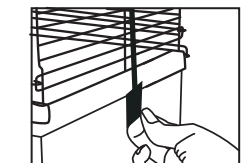

### SAFETY

To safely secure your pet inside the home, firmly press the "Z-Lock" Latch behind the 2nd horizontal cage bar above the door opening.

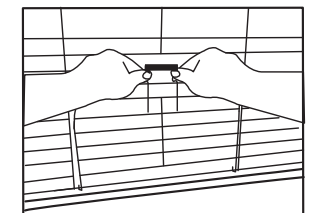

### CLEANING

To clean your pet's home, simply unsnap the Wire Panel Set (A) from the Glass Aquarium. Empty and wash or spray with Kaytee® Clean Cage (Item # 100079553), wipe dry, refill with fresh bedding material, and replace the Tank Topper onto the Glass Aquarium. Kaytee® Clean Cage neutralizes odors, safely cleans surfaces, and is non-toxic to all pets.